

INSTRUCTIONS FOR ASSEMBLING "SPEEDY ALUMINIUM SCAFFOLDING" IN TOTAL SAFETY

EN 1004 CLASS 3 - Charge 200kg/m²

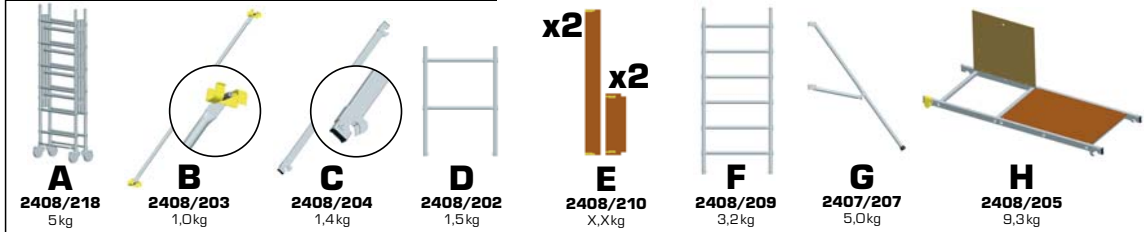

3 T SAFETY METHOD PRINCIPLES OF ASSEMBLY



CAUTION The assembly of a mobile scaffold tower may only proceed when the following SAFETY RULES have been read and understood completely:

- The regulations of EN1004 "Mobile Scaffold Towers" applies for the stability, assembly and use of this scaffold tower. According to EN 1004 the maximum platform heights are limited to 8.00 m. outdoors and 12.00 m. in fully enclosed spaces.
- The mobile scaffold tower may only be assembled, used and dismantled by persons familiar with these Assembly and Use Instructions.
- Do not erect any mobile scaffolding tower, which has damaged or missing parts. Use only original manufacturers undamaged parts.
- The mobile scaffold tower may only be erected on a horizontal surface with a sufficient load-bearing capacity. Use only sound rigid weight distributing bases if necessary. Do not erect a scaffold tower on unstable ground.
- Check all parts for correct assembly and operation prior to use of the mobile scaffold tower.
- Ensure that the scaffold tower is always level. Ensure that the tower cannot be moved or roll away. Use height adjustable legs to ensure levelling. Ensure that castors/base plates are in contact with the ground at all times. Always check that all castor brakes are locked by pushing down the brake levers or use the base plates.
- Always use the stabiliser legs to ensure stability. Always check that all brace and platform hooks are fully locked into place. Always check that all end frame spring clips are engaged. Always replace any missing parts prior to use.
- Ensure that the mobile scaffold tower is within the maximum platform height as stated and that the appropriate stabilisers are fitted.
- All mobile scaffold tower platforms may only be used with complete side guardrails and knee rails; toeboards must be fitted to all working platforms.
- When used outside, mobile scaffold towers should, wherever possible, be secured to a building or other structure. It is good practice to tie in all scaffold towers of any height, especially when left unattended or in exposed windy conditions. Use only the recommended wall anchors.
- Beware of strong wind conditions. Do not erect or use a freestanding tower if the wind speed is likely to exceed 7.7 m/sec (17 mph or Beaufort Force 4). Take care when using mobile scaffold towers in hangers or uncovered buildings as wind force may be increased due to funnelling effects.

- Never climb a tower from the outside. Never climb on the horizontal or diagonal braces. You should only climb the tower on the inside using the ladder end frames.
- Do not lean ladders against the tower. Never use ladders or boxes to gain additional height.
- Ensure that all personnel, tools and materials are removed from the tower prior to moving it. Only move the scaffold tower manually on a firm level surface, which is free of any obstacles. Only move it longitudinally or diagonally. Do not exceed normal walking speed. Raise the stabilisers 12 mm (1/2") from the ground. After moving re-lock the castors, check that the tower is level and ensure that the stabilisers are secure and have a firm footing.
- The maximum capacity of the working platform for an evenly distributed load is 1.5 kN/m² (according to HD1004 - scaffold tower Class 2) Do not exceed the safe working load of the platform.
- Stabilisers and ballast weights shall always be fitted where specified. Ballast is used at the base to stabilise towers from overturning. Ballast must be of solid material (i.e. NOT water or loose sand) and should be positioned so as not to overload individual legs. Ballast should be secured from accidental removal.
- Never jump on to or off the platforms.
- Do not use any lifting equipment on the mobile scaffold tower.
- Beware of overhead obstructions or electric power lines.
- Do not bridge between the mobile scaffold tower and buildings.

MAINTENANCE RULES

Keep equipment clean and inspect before and after use for damage. Use serviceable equipment only. All working parts e.g. castors, adjustable legs; stabiliser clamps should be lubricated lightly with oil. Repairs should only be carried out by the supplier or other competent person approved by the supplier.

WARNING

INJURY OR DEATH MAY RESULT FROM FAILURE TO COMPLY WITH THE ASSEMBLY INSTRUCTIONS, BASIC SAFETY NOTES, MAINTENANCE RULES, SAFE WORKING LOADS AND MAXIMUM PLATFORM HEIGHT OF TOWER.

ASSEMBLING SCAFFOLDING FOR THE RIGHT WORK HEIGHT

3,00 m - Quick Erect Aluminium Scaffold Tower

Work height 3 m - Maximum platform height 1 m: Pack 1

Product Code	Description	Part	Quantity
2408/218 + 2408/200	Folding base frame with fitted wheels	A	1
2408/203	Diagonal Brace	B	1
2408/205	Trapdoor Platform	H	1

- Open folding base **A** and insert the locking pin in the centre of the folding section.
- Place diagonal **B** on one side on the first rung and on the 4th on the other side. Make sure that the butterfly locking part is completely rotated to hold the diagonal firmly in position.
- Place platform **H** on the third rung from the bottom.

Lock all wheels prior to using the scaffold

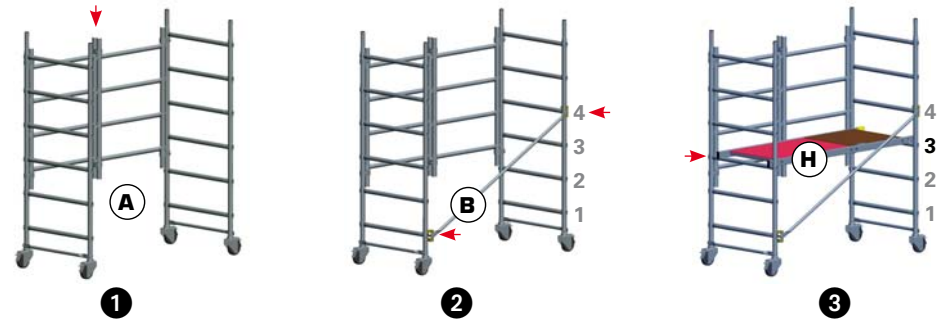

4,00 m - Quick Erect Aluminium Scaffold Tower

Work height 4 m - Maximum platform height 2 m: Pack 1 + Pack 2

Product Code	Description	Part	Quantity
2408/218 + 2408/200	Folding base frame with fitted wheels	A	1
2408/203	Diagonal Brace	B	2
2408/205	Trapdoor Platform	H	1
2408/204	Horizontal brace	C	5
2408/102	1 m Guardrail end frame	D	2
2408/210	Toeboard set (2 long side, 2 short end)	E	1

- Open folding base **A** and insert the locking pin in the centre of the folding section.
- Place diagonal **B** on one side on the first rung and on the 4th rung on the other side. Make sure that the butterfly locking part is completely rotated to hold the diagonal firmly in position.
- Place horizontal brace **C** on the first rung and lock in position.
- Attach a diagonal **B** onto the lower rung of one of the two-rung guardrail end frames **D**. Position the first two-rung guardrail end frames **D** (without the diagonal) on the base and then put the two-rung guardrail end frames **D** already equipped with the diagonal on the other side of the base. (Make sure to put the diagonal on the opposite side to the one already on the base). Make sure that the butterfly locking part is completely rotated to hold the diagonal firmly in position.
- Once end frames **D** are in position, put the 4 locking pins in place and attach the base of diagonal **B** on to the 5th rung of the base frame **A**.
- Place platform **H** on the 6th rung from the bottom. Lock the wind lock firmly into position.
- Climb through the trapdoor, sit on the edge and position the two lower horizontal braces **C** on the 2nd rung from the top. Lock the snaplocks firmly in position.
- Remaining seated in the same position, put the other two rails **C** into position on the top-most rungs. Lock the snaplocks firmly into position.
- Lastly install the toeboards **E**.

Lock all wheels prior to using the scaffold

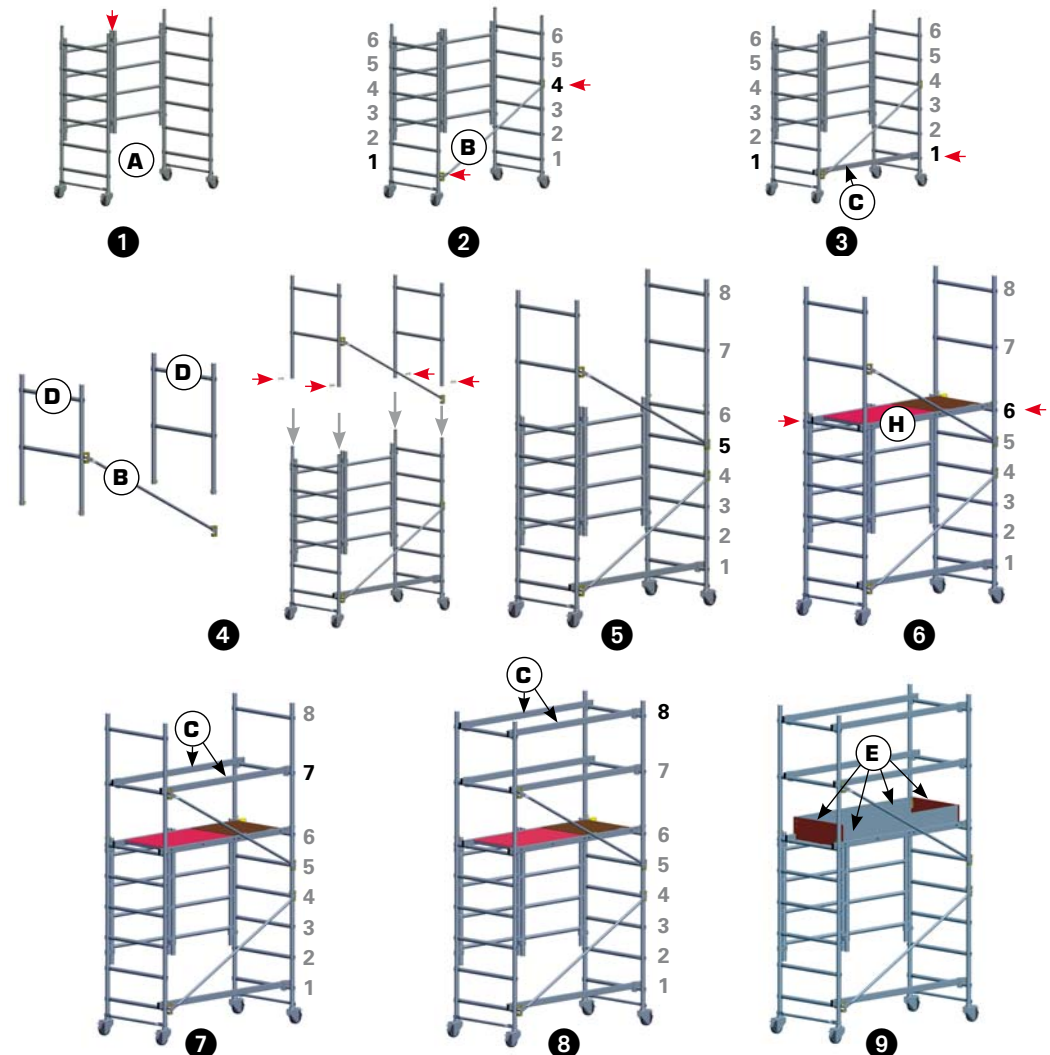

3 T SAFETY STANDARD - THROUGH THE TRAP

Construction - Basic principles - Once the platform has been installed, climb, using the approved method and SIT IN THE TRAPDOOR OPENING.

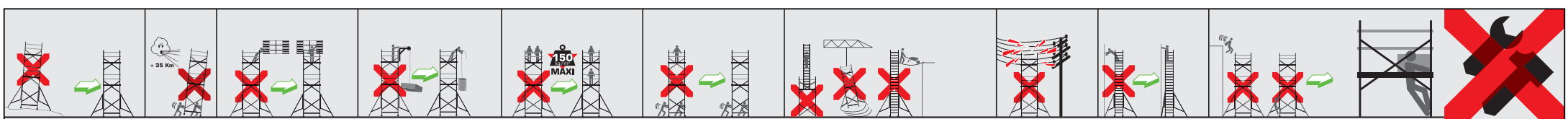

5,50 m - Quick Erect Aluminium Scaffold Tower

Work height 5,50m - Maximum platform height 3,5m: Pack 1+ Pack 2 + Pack 3

Product Code	Description	Part	Quantity
2408/218 + 2408/200	Folding base frame with fitted wheels	A	1
2408/203	Diagonal Brace	B	4
2408/205	Trapdoor Platform	H	2
2408/204	Horizontal brace	C	9
2408/102	1 m Guardrail end frame	D	2
2408/210	Toeboard set (2 long side, 2 short end)	E	1
2408/209	6 rung end frame	F	2
2408/207	Stabiliser leg	G	4

- Open folding base **A** and insert the locking pin in the centre of the folding section. Place diagonal **B** on one side on the first rung and on the 4th rung on the other side. Make sure that the butterfly locking part is completely rotated to hold the diagonal firmly in position.
- Place horizontal brace **C** on the first rung and lock in position.
- Take the two 6 rung end frames, **F** and 3 diagonals **B**. Position a diagonal on the topmost rung of one frame and another diagonal on the second rung of the same frame but on the other side. The last diagonal is to be placed on the top rung of the second end frame. Make sure that the butterfly locking part is completely rotated to hold the diagonal firmly in position. (**WARNING: Make sure that everything is the right way round as per the sketch!**)
- Position the end frames on to the folding base and lock the lower diagonal **B** to the 5th rung of the base frame. Make sure that the butterfly locking part is completely rotated to hold the diagonal firmly in position. Put the 4 locking pins in place to hold the frames to the base.
- Position the 4 stabiliser legs **G** as per the heights indicated on the sketch. Tighten firmly at the correct angle as shown below.
- Position platform **H** on the 5th rung from the bottom
- Climb through the trapdoor, sit on the edge and position the two horizontal braces **C** on the 7th rung from the bottom and the 2 braces **C** on the 9th rung. Lock the snaplocks firmly in position.
- Stand up on the platform and fix the 2 diagonals **B** hanging from the frames into position. Make sure that the butterfly locking part is completely rotated to hold the diagonal firmly in position.
- Put the two 2-rung guardrail end frames **D** into position. Slide them onto the frames beneath and secure with locking pins.
- Place a platform **H** on the 12th rung from the bottom. Climb through the access hatch, sit on the edge and position the two horizontal braces **C** on the 2nd rung from the top.
- Remaining seated in the same position, put the other two rails **C** into position on the top-most rungs. Lock the snaplocks firmly in position.
- Lastly install the toeboards **E**.

Lock all wheels prior to using the scaffold; ensure that the stabiliser legs are secure and firmly seated on the ground.

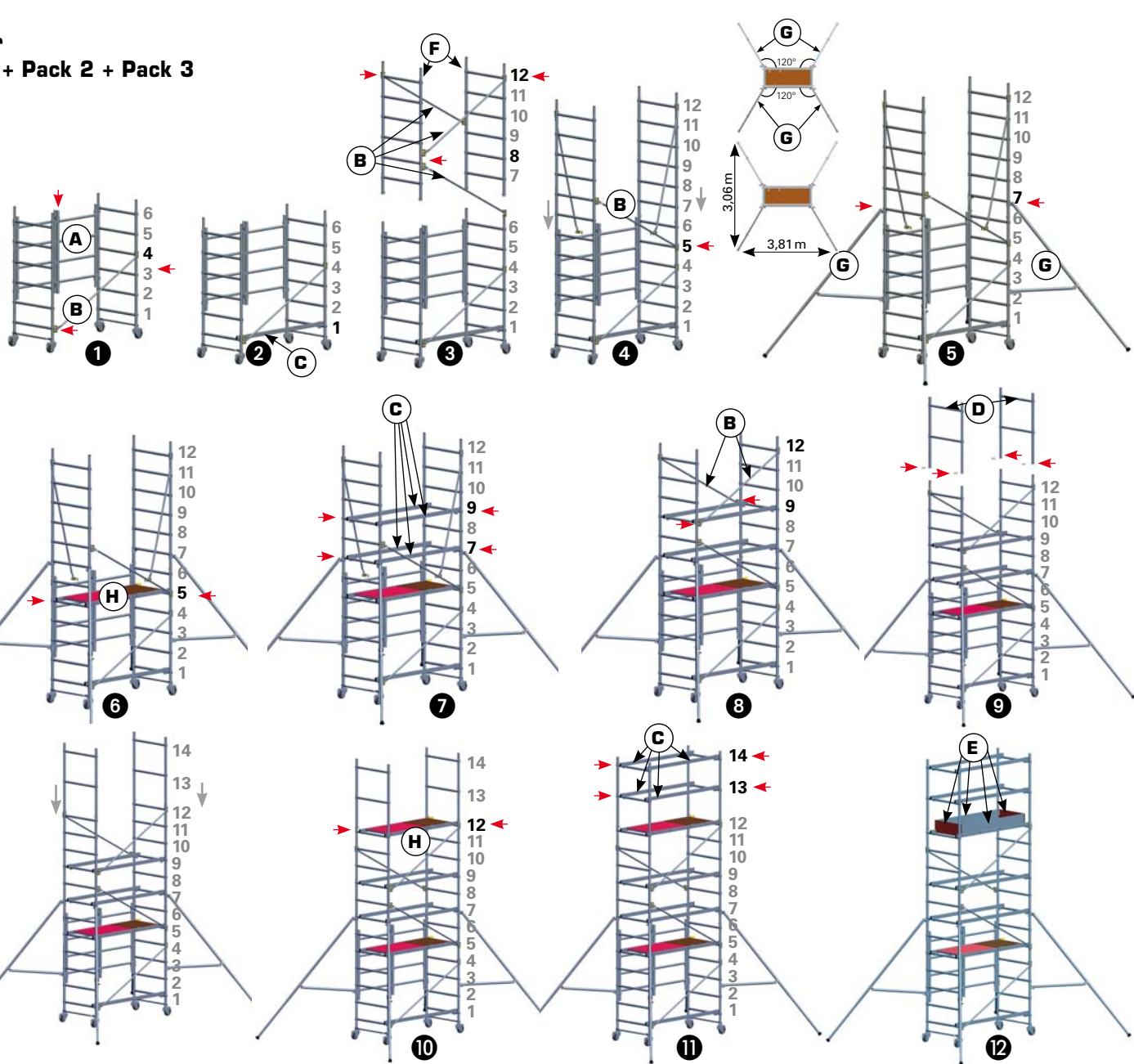

7,20 m - Quick Erect Aluminium Scaffold Tower

Work height 7,20m - Maximum platform height 5,2m: Pack 1+ Pack 2 + Pack 3 + Pack 4

Product Code	Description	Part	Quantity
2408/218 + 2408/200	Folding base frame with fitted wheels	A	1
2408/203	Diagonal Brace	B	7
2408/205	Trapdoor Platform	H	2
2408/204	Horizontal brace	C	9
2408/102	1 m Guardrail end frame	D	2
2408/210	Toeboard set (2 long side, 2 short end)	E	1
2408/209	6 rung end frame	F	4
2408/207	Stabiliser leg	G	4

- Open folding base **A** and insert the locking pin in the centre of the folding section. Place diagonal **B** on one side on the first rung and on the 4th rung on the other side. Make sure that the butterfly locking part is completely rotated to hold the diagonal firmly in position.
- Place horizontal brace **C** on the first rung and lock in position.
- Take the two 6 rung end frames, **F** and 3 diagonals **B**. Position a diagonal on the topmost rung of one frame and another diagonal on the second rung of the same frame but on the other side. The last diagonal is to be placed on the top rung of the second end frame. Make sure that the butterfly locking part is completely rotated to hold the diagonal firmly in position. (**WARNING: Make sure that everything is the right way round as per the sketch!**)
- Position the end frames on to the folding base and lock the lower diagonal **B** to the 5th rung of the base frame. Make sure that the butterfly locking part is completely rotated to hold the diagonal firmly in position. Put the 4 locking pins in place to hold the frames to the base.
- Position the 4 stabiliser legs **G** as per the heights indicated on the sketch. Tighten firmly at the correct angle as shown below.
- Position platform **H** on the 5th rung from the bottom.
- Climb through the trapdoor, sit on the edge and position the two horizontal braces **C** on the 7th rung from the bottom and the 2 braces **C** on the 9th rung. Lock the snaplocks firmly in position.
- Stand up on the platform and fix the 2 diagonals **B** hanging from the frames into position.
- Take 2 of the 6 rung end frames, **F** and 2 diagonals **B**. Position a diagonal on the 4th rung of each frame but on opposite sides. (**WARNING: Make sure that everything is the right way round as per the sketch!**)
- Position the end frames on to frame below and fix the 2 diagonals **B** hanging from the frames into position. Make sure that the butterfly locking part is completely rotated to hold the diagonal firmly in position. Insert the frame locking pins.
- Position a platform **H** on the 11th rung and lock in place.
- Climb through the trapdoor, sit on the edge and position the two horizontal braces **C** on the 13th rung from the bottom and the 2 braces **C** on the 15th rung. Lock the snaplocks firmly in position.
- Attach a diagonal **B** onto the lower rung of one of the two-rung guardrail end frames **D**.
- Position the first two-rung guardrail end frame **D** (without the diagonal) on the base and then put the two-rung guardrail end frame **D** already equipped with the diagonal on the other side of the base. Fix the diagonal in place on the 17th rung. Make sure that the butterfly locking part is completely rotated to hold the diagonal firmly in position. Insert the frame locking pins.
- Climb down to the lowest platform and sitting in the access hatch remove the 4 horizontal braces from rungs 7 and 9 and pass them to the ground.
- Climb to the ground and remove the lower platform.
- Ascend to the platform on rung 11 and reposition the other platform on the 18th rung from the bottom. Lock the windlocks securely.
- Climb through the trapdoor, sit on the edge and position the two lower horizontal braces **C** on the 2nd rung from the top. Lock the snaplocks firmly in position. Remaining seated in the same position, put the other two rails **C** into position on the top-most rungs. Lock the snaplocks firmly into position.
- Lastly install the toeboards **E**.

Lock all wheels prior to using the scaffold; ensure that the stabiliser legs are secure and firmly seated on the ground.

